

- Coaxial line with 7-16 Female connectors
- Small Size and lightweight, double flanges

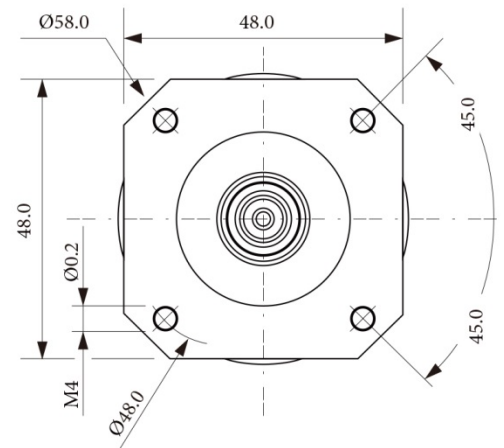
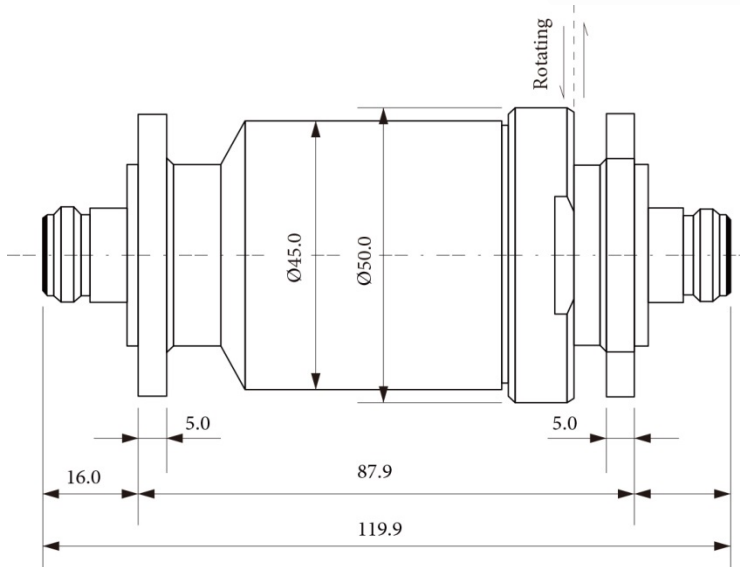
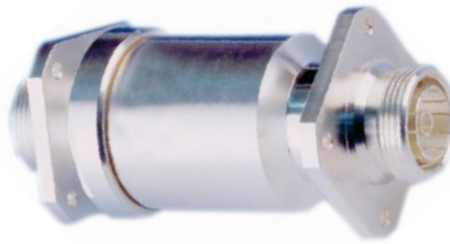

Specifications

Interface Type	7-16 Female – 7-16 Female (50 ohms)	Style	I Type
Frequency Range	DC to 5 GHz	Phase WOW (Degrees Max.)	2°
VSWR, Max.	1.10 @ DC to 5 GHz	Insertion Loss, Max.	0.2 dB @ DC to 5 GHz
VSWR WOW	0.006	Insertion Loss WOW	0.02 dB
Peak Power, Max.	10 kW	Average Power, Max.	600 W
Rotating Speed, Max.	200 rpm	Life Time, Min.	10 Million Revolutions
Starting Torque	1 Nm Max.	Continuous Rotational Torque	1 Nm Max.
Axial Load On Interface, Max	± 30 N	Radial Load On Interface,Max.	± 30 N
Nut Material	Brass	Contact Pin Material	Beryllium Copper
Nut Surface Finish	Tin-Zinc-Copper-Alloy	Contact Surface Finish	Gold Plated
Body Material	Copper Alloy	Body Surface Finish	Silver Plated
Weight	1 kg	Marking	Adhesive Label
Insulator Material	PTFE / Teflon	IP Protection Level	IP 64 Per EN 60529
Temperature (Ambient Range)	-40 to +85°C (Operation)	Humidity (Non-Condensing), Max.	95% (Operation)
	-40 to +85°C (Storage)		95% (Storage)

Molexy reserves the right to change this Datasheet without notice!